

A-1549 lift & turn compression latch

IP65

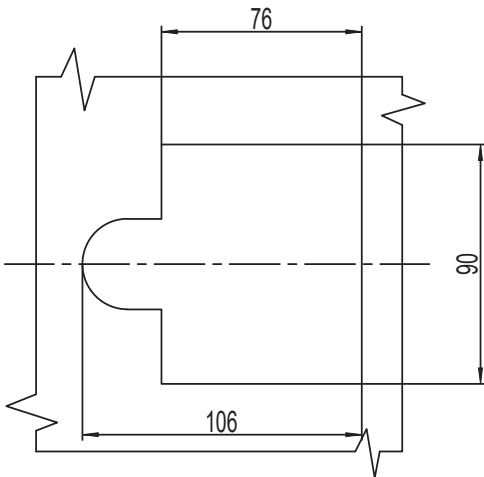

开孔尺寸
Panel Cutout

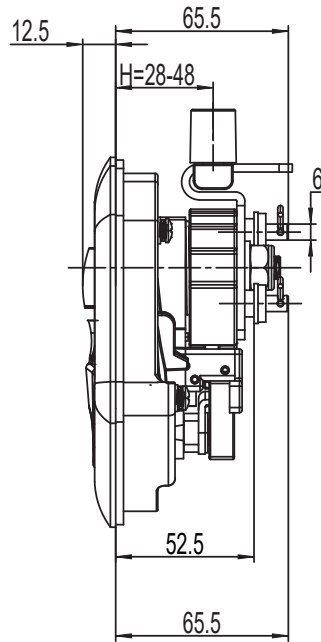
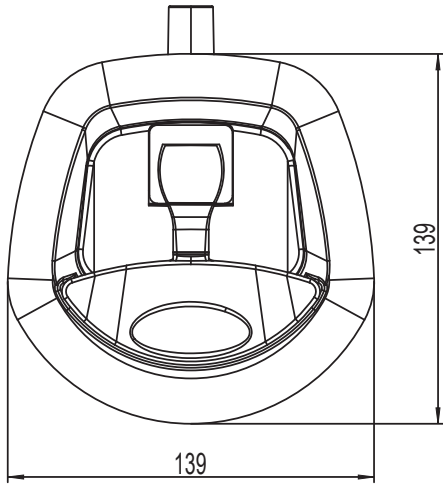

1. Material and surface treatment:
Lock body, handle: Zamak DIN-EN 1774-ZnAl4Cu1 or SUS304
Steel bolt: iron galvanized
Sealing ring: EPDM foam.

2. Performance parameters:
Protection class: IP65
Handle bearing torque value: $\leq 31\text{N}\cdot\text{m}$
Steel bolt bearing capacity: $\leq 4000\text{N}$

1. 材质及表面处理:
锁体, 手柄: 5# 锌合金 或 SUS304
螺栓: 铁镀锌
密封圈: EPDM 发泡胶。

2. 性能参数:
防护等级: IP65
手柄承载扭矩值: $\leq 31\text{N}\cdot\text{m}$
螺栓承载力: $\leq 4000\text{N}$

喷塑黑 Powder coating black	电镀亮铬 Bright chrome plating	底座喷塑黑, 手柄电镀亮铬 Base spray black, handle plated bright chrome
A-1549-40	A-1549-40	A-1549-34