

compression cam latch

**I-3004**

垂直  
(图示为左侧驱动装置)  
Vertical  
(The picture shows the drive on the left)

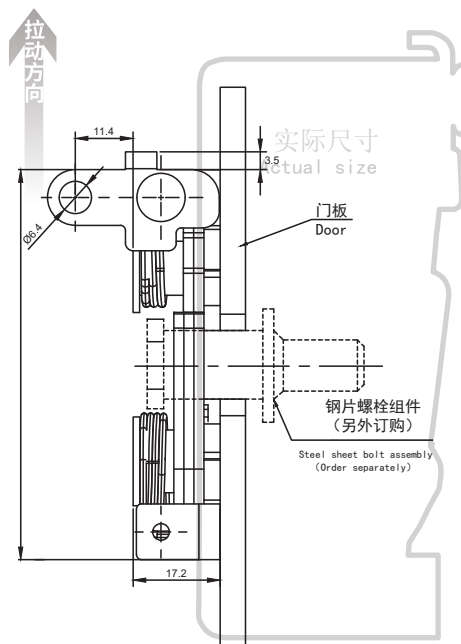
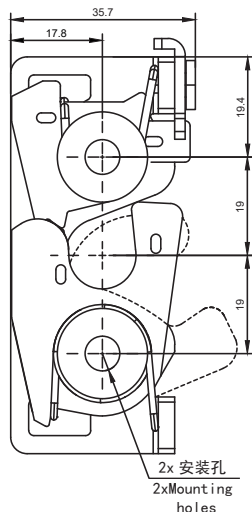

两点式驱动装置  
(图示为左侧驱动装置)  
Two-point drive  
(The picture shows the drive on the left)

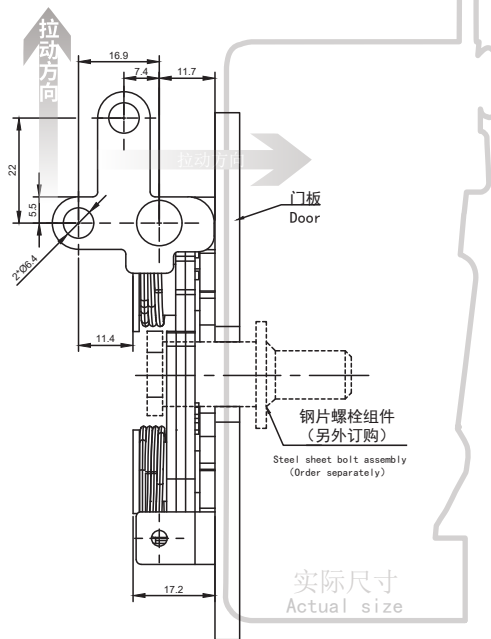
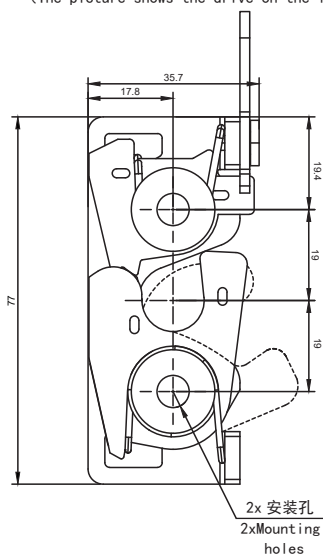

如需获得产品3D模型图，请联系 WWW.FORND.COM

1. Material and surface treatment:  
Main body: Carbon steel galvanized or SUS304

1. 材质及表面处理:  
主体: 碳钢镀锌或 SUS304

**选型 Model selection**

1. 单级, 左侧 Single stage, Left side
2. 单级, 右侧 Single stage, Right side
3. 双极, 左侧 Double stage, Left side
4. 双极, 右侧 Double stage, Right side

1. 垂直 Vertical drive
2. 两点式 Two-point drive
3. 顶部驱动 Top drive
4. 双拉杆 - 底部及垂直 Double tie rod - bottom and vertical

**3004-SI-BL-10**

10. 碳钢镀锌 Galvanized iron  
A1.SUS304

1.  $\Phi 6.7$  通孔 Through-hole
2. 1/4-20 螺纹 Screw thread
3. M6x1 螺纹 Screw thread

1. 标准 Standard
2. 带减震器型号 With shock absorbers